

# 3-way ball valve VZBA

**FESTO**

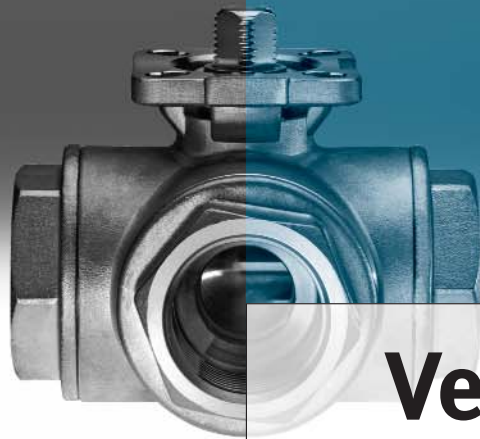

## Versatile!

### Even more versatility in process automation:

with the VZBA 3-way stainless steel ball valve.

For smooth and simple control of aggressive media or gases in piping systems.

### Versatile

An ideal solution wherever processes grow more complex: the VZBA ball valve. For example, when rinsing two containers at the same time or mixing a combination of essences.

### Complete

Complete equipment from one reliable single-source partner with the right products and services – makes processes more reliable and more cost effective, throughout the entire value creation sequence.

Furthermore with the VZBA you have the functionality of two ball valves integrated in one unit.



Two-in-one!

Stainless steel!

Complete system!

910.5.PSI →

Product Short Information

# 3-way ball valve VZBA

## Technical Features:

- 3-way ball valve with female thread
- Ball with L or T connections
- Housing operating shaft and ball all made of stainless steel
- Add-on flange in compliance with ISO 5211
- Ball seal made of PTFE
- Temperature range: -10°C ... +140°C (depending on pressure)

## Ball valve with L connections

Designation
VZBA-R14-63-32L-F0304-R
VZBA-R38-63-32L-F0304-R
VZBA-R12-63-32L-F0304-R
VZBA-R34-63-32L-F0405-R
VZBA-R1-63-32L-F0405-R
VZBA-R114-63-32L-F0405-R
VZBA-R112-63-32L-F0405-R
VZBA-R2-63-32L-F0507-R

## Ball valve with T connections

Designation
VZBA-R14-63-32T-F0304-R
VZBA-R38-63-32T-F0304-R
VZBA-R12-63-32T-F0304-R
VZBA-R34-63-32T-F0405-R
VZBA-R1-63-32T-F0405-R
VZBA-R114-63-32T-F0405-R
VZBA-R112-63-32T-F0405-R
VZBA-R2-63-32T-F0507-R

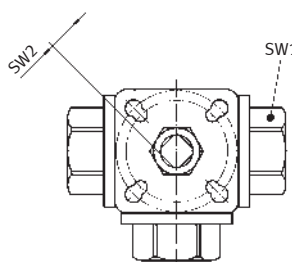
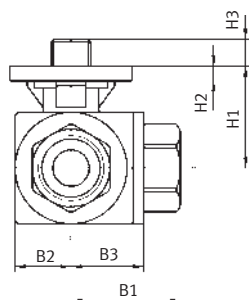
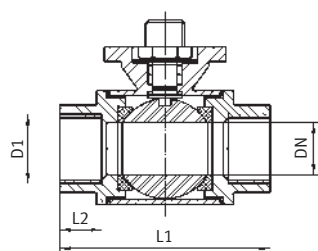

Type	ISO 5211	DN	D1 DIN2999	B1	B2	B3	H1	H2	H3	L1	L2	SW1	SW2	Nm
VZBA-R14-63-32L-F0304-R	F03.04	11.6	Rp1/4"	40	22.4	30	36	6.0	7.4	80	16	23.3	9	8
VZBA-R14-63-32T-F0304-R														
VZBA-R38-63-32L-F0304-R	F03.F04	12.5	Rp3/8"	40	22.4	30	36	6.0	7.4	80	16	23.3	9	8
VZBA-R38-63-32T-F0304-R														
VZBA-R12-63-32L-F0304-R	F03.F04	12.5	Rp1/2"	40	22	31	36	6.0	8.4	80	17.4	27.2	9	8
VZBA-R12-63-32T-F0304-R														
VZBA-R34-63-32L-F0405-R	F04.F05	15.0	Rp3/4"	44	23	34.7	42	6.2	12.0	88	20	32.5	11	11
VZBA-R34-63-32T-F0405-R														
VZBA-R1-63-32L-F0405-R	F04.F05	20.0	Rp1"	51	32	40	47	6.3	12.0	100	20.5	41.3	11	18
VZBA-R1-63-32T-F0405-R														
VZBA-R114-63-32L-F0405-R	F04.F05	25.0	Rp1 1/4"	62	36	47.2	53	6.7	11.0	123	24	50.5	11	26
VZBA-R114-63-32T-F0405-R														
VZBA-R112-63-32L-F0405-R	F04.F05	32.0	Rp1 1/2"	71	43	53	59	7.0	10.8	142	26.6	57.7	11	32
VZBA-R112-63-32T-F0405-R														
VZBA-R2-63-32L-F0507-R	F05.F07	40.0	Rp2"	86	55	63.5	66	6.2	15.8	171	27.6	70.7	14	37
VZBA-R2-63-32T-F0507-R														

## Switching positions

Port	1	2	3	4
Type L	1 ⊕ 2 3	1 ⊕ 2 3	1 ⊕ 2 3	1 ⊕ 2 3
Type T	1 ⊕ 2 3	1 ⊕ 2 3	1 ⊕ 2 3	1 ⊕ 2 3

↑ Delivery configuration

## Festo AG & Co. KG

Ruiter Strasse 82  
73734 Esslingen  
Internet [www.festo.com](http://www.festo.com)  
Tel. ++49 (0)711 347-0  
Fax ++49 (0)711 347-2144  
E-mail [service\\_international@festo.com](mailto:service_international@festo.com)

Subject to change

070705